

## PRODUCT ILLUSTRATION

When the headset and bluetooth device has not connected successfully or did not connect, 15 minutes later, the earphone will be off automatically by default to save power.

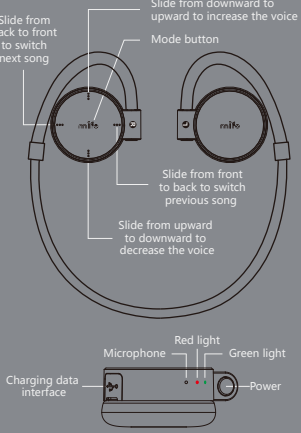

EN

## PAIRING

1. Turn on bluetooth on your phone.
2. Press the power button on the headset Into the pairing mode(green and red LED lights alternate flashing):



NOTICE: If your mobile phone bluetooth version is below version 2.1, then you need to enter password "0000".

IMPORTANT: If the pairing can't be completed within 90 seconds while the pairing mode is activated, it means the pairing is unsuccessful, please repeat Step1 to Step3 to pair the headset with the bluetooth device again

EN

## CHARGING

LED indicator display status

- When the battery is low, LED red light will flash 2 times continuously.
- Charging (red light keep on)
- Full charged (green light keep on)



Please use original Mirco USB charging cable or brand charging cable to charge. It will take 1-2 hours to charge fully. Don't use small current power bank to charge, it probably can't charge.

## BUTTON FUNCTION

## ① POWER ON/OFF



EN

## BUTTON FUNCTION

## ② ANSWER 1 / HANG UP THE CALLING



## ③ ANSWER 2 (keep talk with 2 person at same time)

When talking with 1 phone, there is calling from 2. click power button, keep the current talking and answer the new calling. hold on power button to hang up the current calling, double click power button to hang up the new calling.



EN

## BUTTON FUNCTION

## ④ ANSWER 3/REJECT THE PHONE

When talking with 1 phone, there is calling from 2. A. double click power button, reject the calling from 2. B. click power button, hang up the phone from 1, answer the calling from 2.



## ⑤ LAST NUMBER REDIAL

In the Bluetooth connected state double-click the power key to redial the last number (callback)

## TOUCH SCREEN FUNCTION

## ① NEXT/PREVIOUS SONG

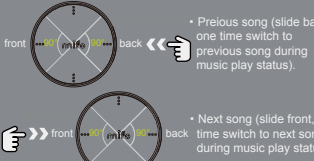

## ② INCREASE/DECREASE THE VOICE

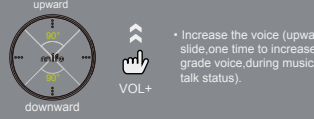

EN

## TOUCH SCREEN FUNCTION

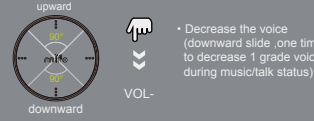

## ③ MODE SWITCH



## DATE TRANSMISSION FUNCTIONS

Built in storage, Use MIRCO head to connect with headset, and USB head connected to computer, you will hear the notification tone "in date connection", you can transmit song or other date from computer to the memory of headset.

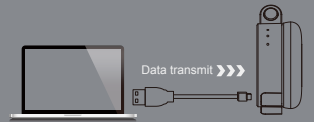

EN

## STEP CALCULATING APP

## ONLY SUPPORT IOS DEVICE

Enter into the APP store search "mifo smart" and download APP, before using, please connect headset with mobile phone Bluetooth firstly, then enter into the app menu and select mifo FO to connect. APPS contains "sports step counting, local music play, online music, and other functions. the detail operation please check the app surface.

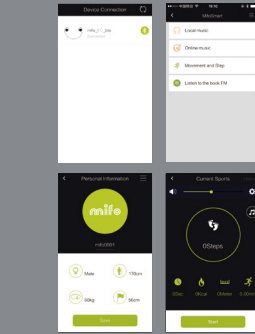

NOTICE: China:Chinese Korea:Korea Other countries:are English

EN

## FREQUENTLY ASKED QUESTIONS

Why bluetooth headset can not turn on?

1. You can check if headphone is with power, if not, please charge it fully before turning it on.
2. Please Hold "Power button" for 3 seconds.

Why bluetooth headset signal is not stable?

1. Restart the bluetooth headset.
2. Please kindly check the compatibility of the mobile phone and calling communication quality.
3. Then confirm if the distance between headphone and phone is too far or there are interference surrounded. If too far or there are interference, the signal will be not stable.
4. Please don't stay in the signal reflective environment.

Why the bluetooth headphone's noise is so big?

1. Please kindly check the mobile phone's noise suppression function.
2. Please kindly check if the bluetooth headphone and mobile phones distance is out of 10 Meters.
3. Please kindly confirm if you are in an electromagnetic radiation surrounding environment.

EN

Why bluetooth headset can't hear voice?

1. Please kindly check if the bluetooth headset is on mute
2. Please check if bluetooth headphone and phone is connected well.
3. Then confirm if the distance between headphone and phone is too far or there are interference surrounded.

EN

MAKE  
IT FULLY OPTIMALDESIGNED AND MADE BY  
Mifo Technology Co., Ltd.

Tel: +86-755-29708999  
Fax: +86-755-29708999  
Email: mifo@mifo.hk  
www.mifo.hk

PN: F05001

## 产品说明图

耳机未和手机等设备连接状态下,系统默认15分钟后会自动关机以节约电量。

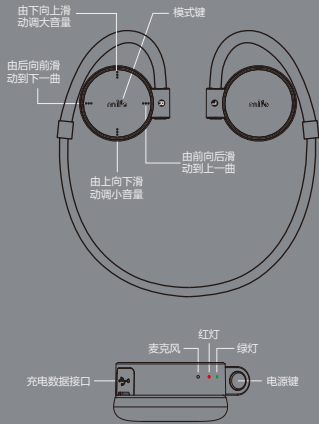

CH

## 配对

① 可与手机, 平板电脑, 台式电脑, 笔记本等带蓝牙的设备配对

1. 开启手机蓝牙:
2. 长按耳机电源键开机进入配对模式(红绿灯交替闪烁):
3. 搜索Mifo-F0进行配对连接(连接成功后耳机有提示):

提示:

1. 已配对的机器,重新开机或在可搜索范围内,可自动回连接,不能连接时,点按开机键或手机打开蓝牙界面,点击配对名称可以回连。
2. 如果配对不能在15分钟内完成,耳机将自动关机,表明配对失败,请再根据以上3个步骤重新配对。

CH

## 配对

3. 若配对不成功或搜索不到蓝牙名称, 请删除手机上的配对名称, 或在耳机开机状态下插入USB充电复位, 重新搜索配对, 直到配对成功。

## 充电方式

LED指示灯显示状态

- 电量低 (每隔2秒闪2下)
- 充电中 (红灯常亮)
- 电池充满 (绿灯常亮)

本机须使用原装充电线进行充电, MIRCO USB线连接 5V(1A-2A)电源适配器, 5V(1A-2A)车载充电头, 推荐使用2A以下的电源适配器给耳机进行充电, 蓝牙耳机充满电需约2小时左右, 不能使用小于100毫安的电源适配器、车载充电头, 这样会导致不能给耳机充电。

## 按钮功能

## ① 开/关机

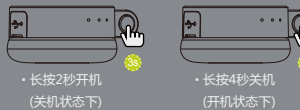

CH

## 按钮功能

## ② 接听/挂断电话



## ③ 接听2 (3方通话)

当电话1通话, 电话2来电; 单击电源键, 保持电话1通话并接听电话2, 在三方通话状态下, 长按电源键挂断电话1; 在三方通话状态下, 双击电源键挂断电话2。



CH

## 按钮功能

## ④ 接听/拒接电话

当电话1通话, 电话2来电; A. 双击电源键, 挂断电话2保持电话1通话。 B. 单击电源键, 挂断电话1接通电话2。



## ⑤ 末位号码重拨

## 触摸屏功能

## ① 下一曲/上一曲



## ② 音量+/音量-



CH

## 触摸屏功能



## ③ 模式切换

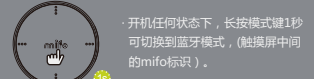

## 数据传输功能(内置存储)

使用数据线MIRCO接头连接耳机, 并且把USB头插入电脑后, 语音提示 "数据连接中" 电路会识别耳机为U盘形态, 此时可从电脑传输歌曲或者其他资料到内存中。



CH

## APP功能 运动记步app使用 (仅支持ios设备)

进入App store搜索 "mifo smart" 进行下载。首次使用, 耳机需连接手机进入APP进行设置; 在连接APP状态下, 可以通过APP操作运动开始与结束; 在未连接APP状态下还可以通过长按电源键操作运动开始与结束, 连接APP可查看运动数据。连接成功后包含有 "运动记步, 本地播放, 在线音乐, 听书FM" 等功能。具体操作请查看APP界面。

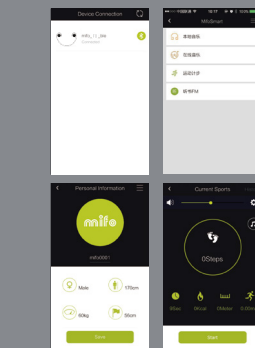

提示: APP语言与手机系统语言相同。

CH

## 常见问题

## 蓝牙耳机不开机?

- ①. 需长按电源键2秒钟左右才会开机;
- ②. 检查蓝牙耳机是否没电, 需进行充电。

## 蓝牙耳机信号不稳定?

- ①. 重新启动蓝牙耳机;
- ②. 查看手机的兼容性 & 手机通话质量;
- ③. 确认蓝牙耳机是否没电或周边环境有干扰;
- ④. 不要停留在信号反射的环境中。

## 蓝牙耳机噪音过大?

- ①. 查看手机的降噪控制;
- ②. 确认蓝牙耳机是否与手机距离过远;
- ③. 确认周边环境是否有电磁辐射。

## 蓝牙耳机听不到声音?

- ①. 检查耳机音量是否调为静音;
- ②. 检查蓝牙耳机是否与手机连接;
- ③. 检查蓝牙耳机是否与手机距离过远或周边有干扰。

CH

## 温馨提示

- 本机充电时请注意使用原装充电器或电脑端口充电, 切不可使用廉价劣质的充电器。
- 产品送保前, 请自行保存好您的资料, 以免丢失。
- 如果产品发生故障, 我们将严格按照国家规定以及我们力所能及的服务为您解答问题, 但我们可能不会为因使用产品而导致的财产损失以及经济损失承担相关法律责任。
- 蓝牙耳机均有使用环境以及连接距离的问题, 请您勿在大电磁干扰和辐射的环境中使用。
- 蓝牙耳机内部有精密电路, 水或者震动均会损坏产品, 请不要将蓝牙耳机置于水中或者摔打, 这些均会造成产品损坏。
- 如果您的蓝牙耳机长时间不使用, 请约30天充一次电, 以防止因缺电而造成的无法启动。
- 我们可能在未事先通知您的情况下, 对于此产品进行一次软件或者硬件以及外观的升级和改动, 请您以实物为准。

CH



您也可以随时加入毫渡官方微信, 查询产品真伪!

毫渡集团(香港)有限公司 (总部)  
服务热线:400-880-7659  
服务支持: bbs.mifo.hk